

REV	DATE	REVISION DETAILS	INIT	IMPERIAL DIMENSIONS		GORDON TECHNOLOGIES Pty. Ltd.	A GORDON GROUP COMPANY	B30-026	DRAWING No.	ISSUE H
H	.08	Redrawn in AutoCad.		NAME	DATE	TITLE				
				DRAWN	kwk	5.5.08	'N' Rt.Angle CABLE PLUG Small Cables		REF. DRGS.	
				APPR'VD			MATERIAL NOTED		FIRST USE:	
							FINISH NOTED			
TOLERANCE UNLESS OTHERWISE SPECIFIED: 2 fig decimal +/- .004" 3 fig decimal +/- .002" Angles +/- 1 deg								SCALE	2:1	

FOR RG58 CABLES

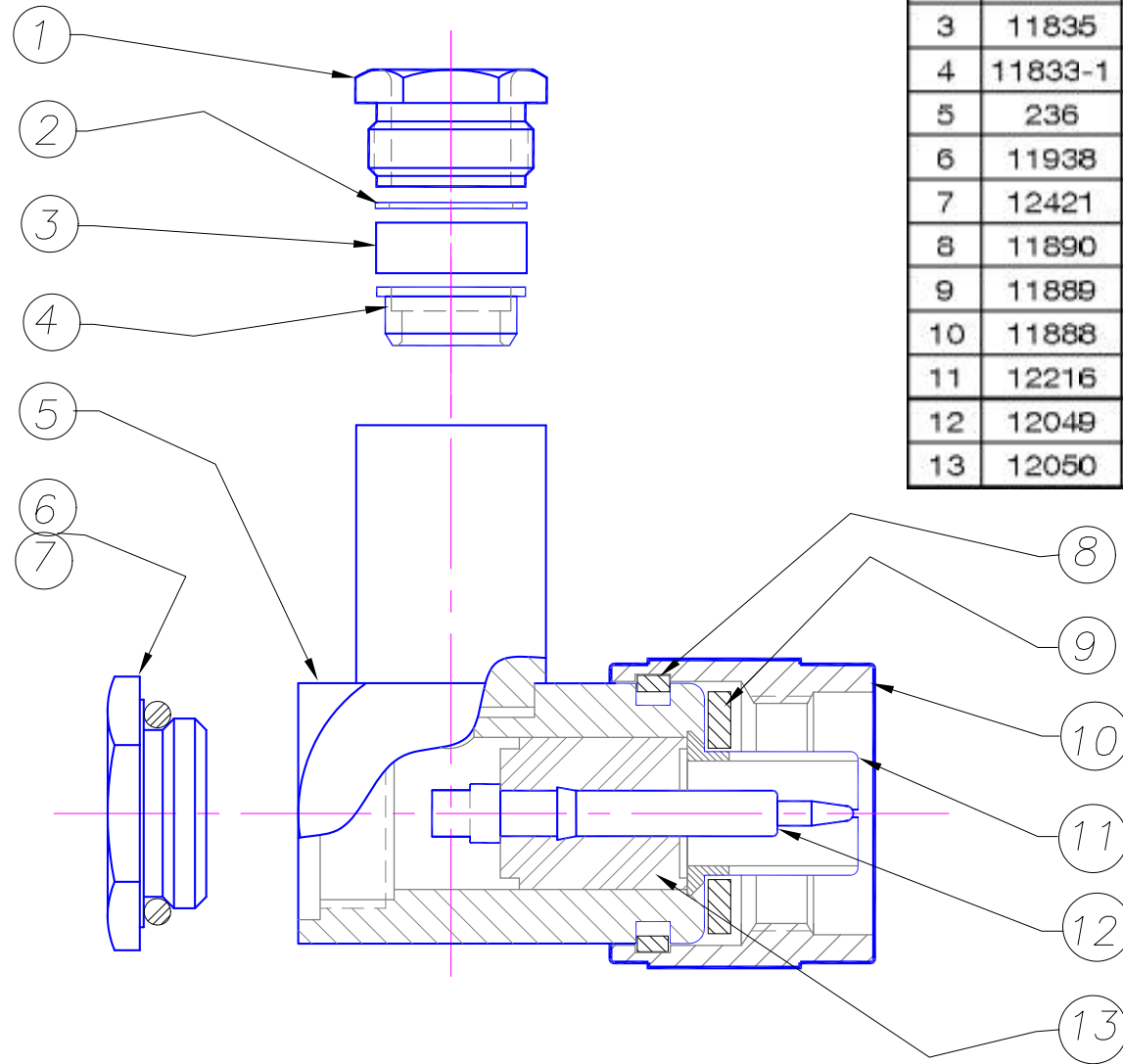

Key	Part No.	DESCRIPTION	Qty.	Material	Finish
1	11832-1	CLAMP NUT	1	Brass	Nickel Plate
2	11834	WASHER	1	Brass	Nickel Plate
3	11835	SEALING RING	1	Neoprene	Black
4	11833-1	COLLET	1	Brass	Nickel Plate
5	236	BODY ASSEMBLY	1	Brass	Nickel Plate
6	11938	HEXAGON PLUG	1	Brass	Nickel Plate
7	12421	O' RING #BS012	1	Nitrile	Black
8	11890	CIRCLIP	1	Brass	Natural
9	11889	GASKET	1	Silicon Rubber	Red
10	11888	SWIVEL NUT	1	Brass	Nickel Plate
11	12216	OUTER CONTACT	1	Brass	Silver Plate
12	12049	CAPTIVE PIN	1	Brass	Gold Plate
13	12050	INSULATOR	1	P.T.F.E.	Natural

COPYRIGHT RESERVED: THIS DRAWING IS THE SOLE PROPERTY OF LINK CONNECTORS P/L & IS RETURNABLE ON REQUEST. IT IS TO BE TREATED AS CONFIDENTIAL, IS NOT TO BE COMMUNICATED TO ANY OTHER PERSON WITHOUT THE WRITTEN CONSENT OF LINK CONNECTORS & MAY BE USED FOR MANUFACTURE, ONLY WHEN ACCOMPANIED BY A WRITTEN ORDER.